

OFFICES

UNIT	#04-01	#04-02	#04-03	#04-04	#04-05	#04-06	#04-07	#04-08	#04-09	#04-10	#04-11	#04-12
AREA	807 FT <sup>2</sup>	467 FT <sup>2</sup>	489 FT <sup>2</sup>	456 FT <sup>2</sup>	845 FT <sup>2</sup>	679 FT <sup>2</sup>	818 FT <sup>2</sup>	790 FT <sup>2</sup>	538 FT <sup>2</sup>	511 FT <sup>2</sup>	651 FT <sup>2</sup>	818 FT <sup>2</sup>

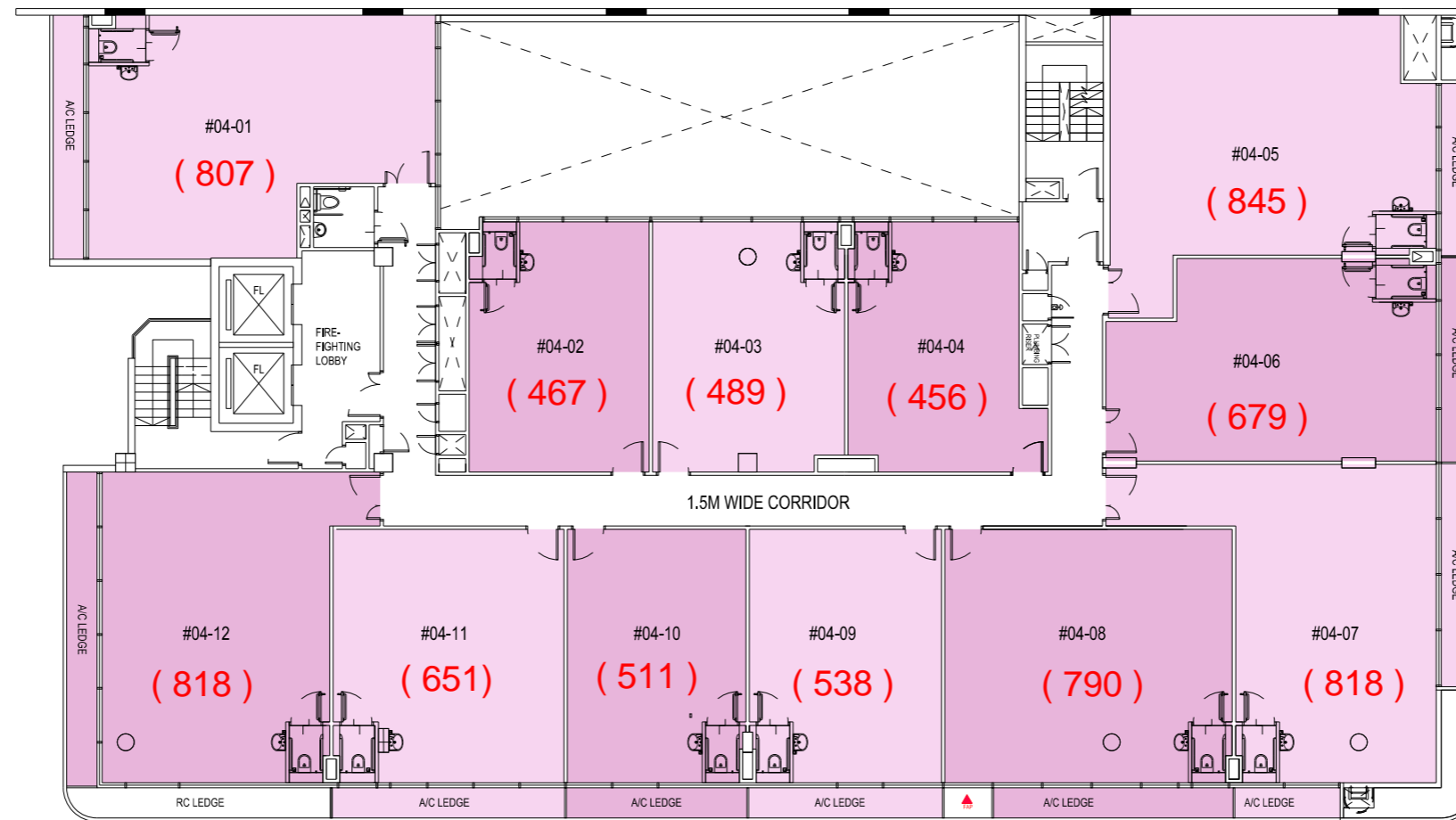

# 4TH STOREY PLAN

CONCEPT STAGE

PROPOSED REDEVELOPMENT INTO A 5-STOREY COMMERCIAL BUILDING COMPRISING SHOPS AT THE BASEMENT, 1ST AND 2ND STOREYS, RESTAURANTS AT THE 1ST STOREY AND OFFICES AT THE 3RD TO 5TH STOREY WITH ATTIC AND BASEMENT CAR PARKS ON LOT 08514V MK26 AT 160 CHANGI ROAD (GEYLANG PLANNING AREA)

