

RESTAURANTS / F&B

UNIT	#01-05	#01-06	#01-07	#01-08
AREA	713 FT <sup>2</sup>	742 FT <sup>2</sup>	790 FT <sup>2</sup>	786 FT <sup>2</sup>

SHOPS

UNIT	#01-01	#01-02	#01-03	#01-04	#01-09	#01-10	#01-11	#01-12
AREA	550 FT <sup>2</sup>	467 FT <sup>2</sup>	442 FT <sup>2</sup>	646 FT <sup>2</sup>	388 FT <sup>2</sup>	413 FT <sup>2</sup>	260 FT <sup>2</sup>	234 FT <sup>2</sup>

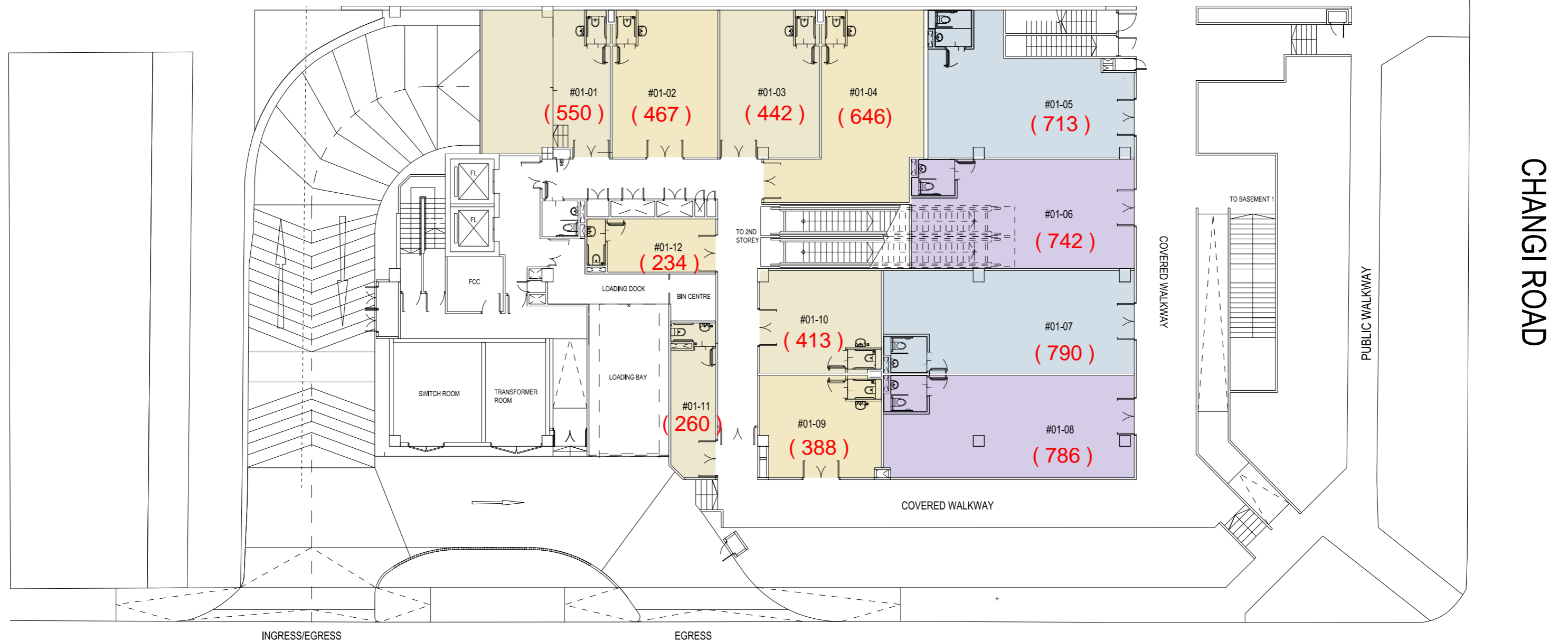

LORONG 105 CHANGI

1ST STOREY PLAN

CONCEPT STAGE

PROPOSED REDEVELOPMENT INTO A 5-STOREY COMMERCIAL BUILDING COMPRISING SHOPS AT THE BASEMENT, 1ST AND 2ND STOREYS, RESTAURANTS AT THE 1ST STOREY AND OFFICES AT THE 3RD TO 5TH STOREY WITH ATTIC AND BASEMENT CAR PARKS ON LOT 08514V MK26 AT 160 CHANGI ROAD (GEYLANG PLANNING AREA)

